



Jeep Cherokee 1997-2001

Visit MetraOnline.com for more detailed information about the product and up-to-date vehicle specific applications

KIT FEATURES

- ISO DDIN radio provision
- Complete panel for a factory look and feel
- Painted scratch resistant matte black

KIT COMPONENTS

- A) Radio dash panel • B) Radio brackets • C) Phillips screw • D) Tape (not shown)

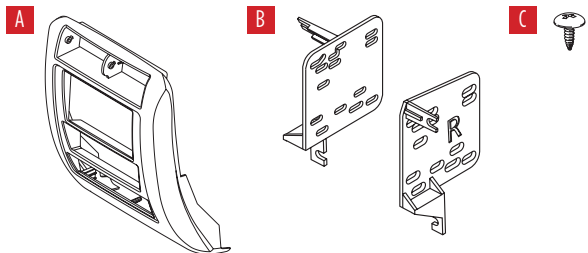

TABLE OF CONTENTS

| | |
|------------------------|-----|
| Dash Disassembly | 2 |
| Kit Preparation | 3-4 |
| Kit Assembly | 5 |

WIRING & ANTENNA CONNECTIONS (sold separately)

Wiring Harness: 70-1817

Antenna Adapter: Not required

TOOLS REQUIRED

- Panel removal tool • Phillips screwdriver
- Cutting tool • 1/8" drill bit • 3/8" socket set

Attention! Let the vehicle sit with the key out of the ignition for a few minutes before removing the factory radio. When testing the aftermarket equipment, ensure that all factory equipment is connected before cycling the key to ignition.

DASH DISASSEMBLY

1. Unclip and remove the radio trim panel. Remove the factory panel clips and A/C vents for re-use in Kit Assembly. (Figure A)
2. Remove (2) $\frac{3}{8}$ " screws securing the radio. Slide the radio out, then unplug and remove.

Continue to Kit Preparation

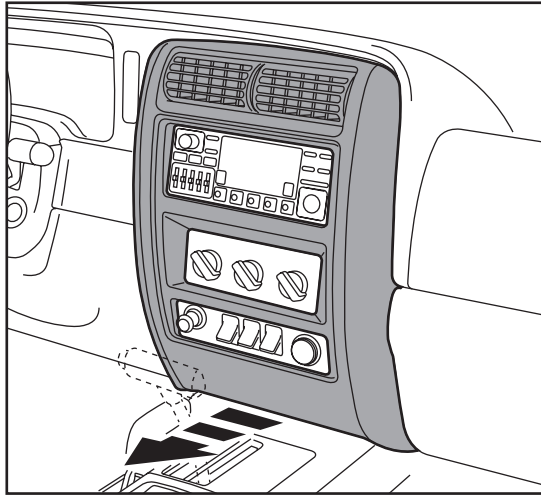

(Figure A)

KIT PREPARATION

Attention! The sub-dash of the vehicle will have to be cut to allow room for the aftermarket radio. Once cut, the factory radio will no longer be able to be re-installed. Also take note that the radio sub-dash is actually the a/c vents for the vehicle. After the sub-dash has been cut, the tape provided will have to be used to cover up the holes to prohibit air from leaking out.

For select Sony radios* with an “L” shaped chassis design:

1. Remove (4) Phillips screws securing the climate controls. Partially slide the controls out and move down slightly.
2. Cut the sub-dash to allow room for the aftermarket radio. (Figure B)

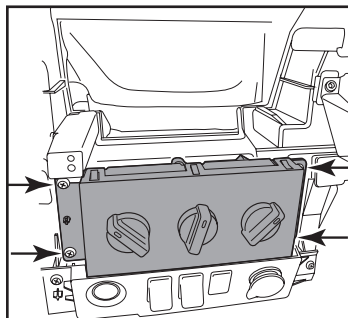

(Figure A)

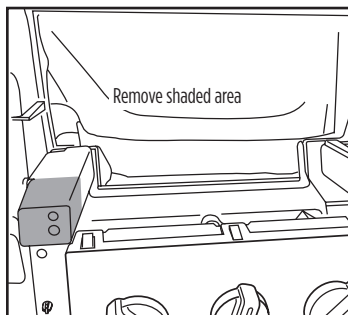

(Figure B)

3. Apply tape over the area cut. (Figure C)
4. Cut the **radio brackets** as shown. (Figure D)
5. Secure the climate controls back to the vehicle using just the (2) lower screws. The upper screws will be reused in Kit Assembly.

* At present (9-12-19), models XAV-AX100, XAV-AX1000, XAV-AX200, XAV-A500, and XAV-V10BT have this design

Continue to Kit Assembly

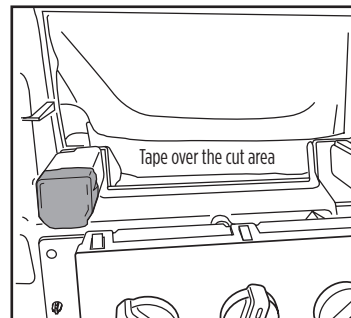

(Figure C)

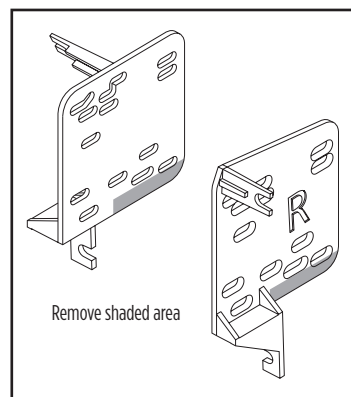

(Figure D)

KIT PREPARATION (CONT.)

For all other radios:

1. Remove (4) Phillips screws securing the climate controls. Partially slide the controls out and move down slightly. (Figure A)
2. Cut the sub-dash to allow room for the aftermarket radio. Take note that "mechless" radios may require less cutting. It is highly suggested to assess the design of the radio and only cut what is truly required to fit the radio into the dash. (Figure B)
3. Apply tape over all areas cut. (Figure C)
4. Secure the climate controls back to the vehicle using just the (2) lower screws. The upper screws will be reused in Kit Assembly.

Continue to Kit Assembly

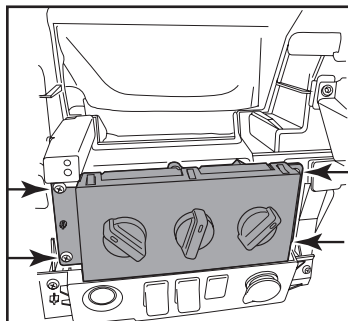

(Figure A)

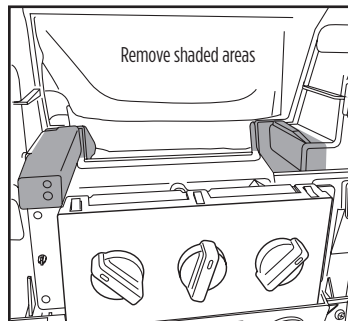

(Figure B)

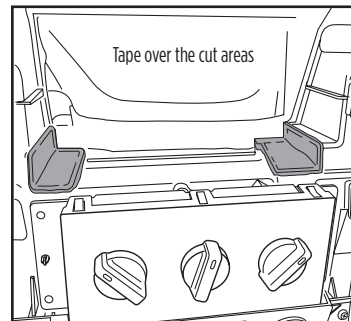

(Figure C)

KIT ASSEMBLY

1. Secure the **radio brackets** to the radio using screws supplied with the radio. (Figure A)
2. Locate the factory wiring harness and antenna connector in the dash and complete all necessary connections to the radio. Metra recommends using the proper mating adapter from Metra and/or Axxess. Test the radio for proper operation.
3. Slide the radio assembly into the dash, then secure using :
 - a. The (2) factory climate control screws down below. (Figure B)
 - b. The factory radio screw in the top right. (Figure B)

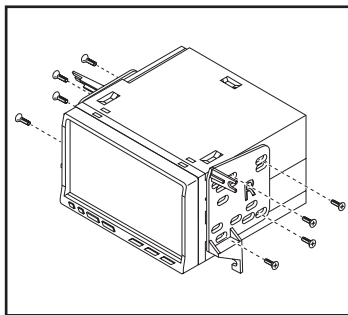

(Figure A)

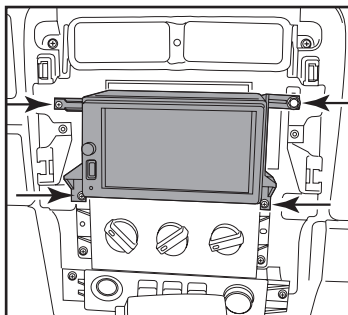

(Figure B)

4. Drill a 1/8" hole in the sub-dash at the top left bracket area, then fully secure the radio assembly using the Phillips screw provided. (Figure B)
5. Attach the factory A/C vents to the 95-6554B **radio trim panel**. (Figure C)
6. Attach the factory panel clips to the 95-6554B **radio trim panel**, then clip the panel onto the dash to complete the installation. (Figure D)

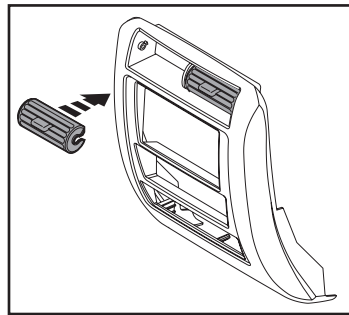

(Figure C)

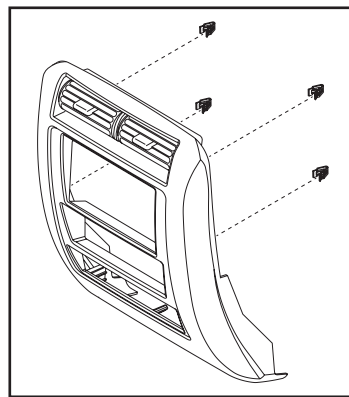

(Figure D)

[illegible]



95-6554B
INSTALLATION INSTRUCTIONS



If you are having difficulties with the installation of this product, contact our Tech Support line either by phone at **386-257-1187**, or email at **techsupport@metra-autosound.com**. Before doing so, look over the instruction booklet a second time and ensure that the installation was performed exactly as the instruction booklet is stated. Have the vehicle apart and ready to perform troubleshooting steps before contacting Metra/Axxess Tech Support.



KNOWLEDGE IS POWER

Enhance your installation and fabrication skills by enrolling in the most recognized and respected mobile electronics school in our industry. Log onto www.installerinstitute.com or call 800-354-6782 for more information and take steps toward a better tomorrow.



**Metra recommends MECP
certified technicians**